

*veritas*<sup>®</sup>  
Variable Burnisher



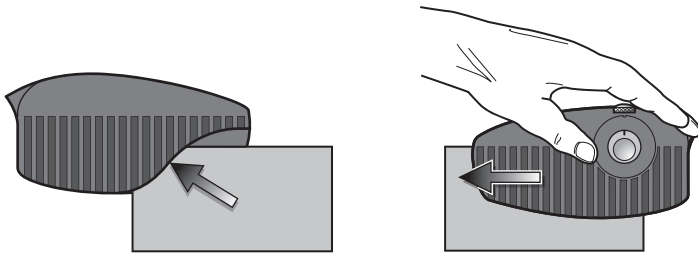
05K37.01

A well-burnished cabinet scraper removes fine shavings, not dust. The Veritas® Variable Burnisher makes the process of putting a hook on a cabinet scraper easy and perfectly repeatable. All you have to do is set the hook angle you want and burnish the clamped scraper. A precision-ground tungsten carbide rod in the brass angle-setting knob is held at exactly the right angle as you burnish. The ergonomic, injection-molded body protects the burnished edge from harm, keeps hands safely clear of sharp edges, and allows you to apply as much pressure as you wish.

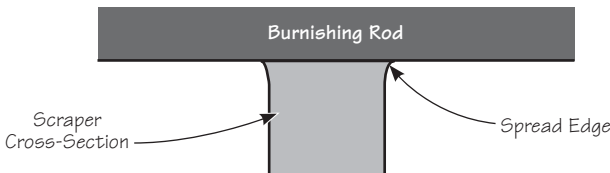
The included cabinet scraper has precision-milled edges. It can be used "as is" or you can burnish hooks on one or more of the four edges according to your needs.

## Using the Burnisher

1. Clamp the scraper in a vise, leaving about 1½" (40mm) exposed.
2. Put a tiny amount of oil on the scraper edge. In fact, rubbing your finger behind your ear and then running it over the scraper (**carefully, the edges are sharp!**) gives you just the right amount of oil.
3. With the dial set and locked at 0°, take two or three passes over the scraper at moderate pressure (**Figure 1**). This will slightly spread the milled face and prepare the edges for the next step (**Figure 2**).

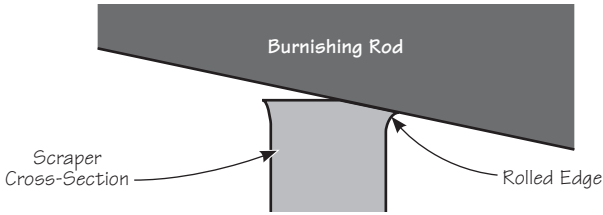


**Figure 1: Take two or three passes over the scraper.**



**Figure 2: Prepare the scraper edges.**

4. Re-set the dial to the hook angle you want, and take one or more passes to roll the scraper edges. Practice soon tells you how many passes will give you a good edge (**Figure 3**).

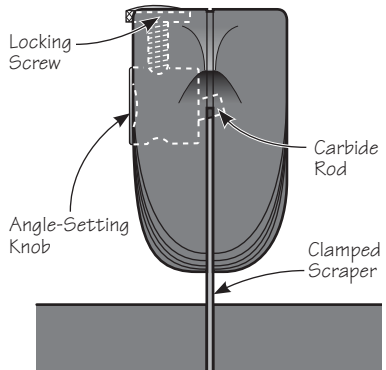


**Figure 3: Roll the scraper edges.**

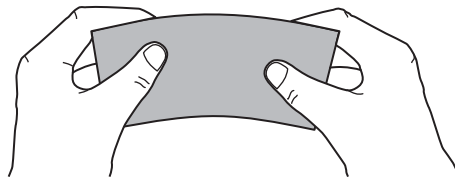
5. To re-sharpen a worn scraper edge, file the edge of the scraper smooth and square (either by hand or with the Veritas® Jointer/Edger 05M07.01) and repeat the above steps.

If the carbide burnishing rod should ever wear from extreme use, simply loosen the set screw holding it in place and rotate the rod to present a new burnishing surface.

**Caution:** *Because the scraper edge is extremely sharp, the body is designed to be used on the pull stroke. For the safest use, place the cutaway section of the body onto the clamped scraper, then pull the burnisher along the edge. You don't need any hook at the ends because the scraper is bowed in use (**Figure 4**). It is not necessary to apply great pressure on the scraper while burnishing; repeated passes will roll the edge of the scraper much more consistently and with minimal effort.*



**Figure 4: Clamp scraper in vise, set knob to desired hook angle, and run burnisher over scraper.**



**Figure 5: Bow the scraper in use.**

# Guide to Hook Angles

Angle	Applications
0°	Fine wood such as marquetry.
0° to 5°	General-purpose wood scraping.
5° to 10°	Faster stock removal.
10° to 15°	Removing paint, varnish, etc.

## Accessories

- 05K30.10** Set of 4 Super-Hard Milled Cabinet Scrapers  
**05K33.01** Veritas® Scraper Holder  
**05M07.01** Veritas® Jointer/Edger

---

**veritas**® Tools Inc.

814 Proctor Avenue    1090 Morrison Drive  
Ogdensburg, New York    Ottawa, Ontario  
13669-2205 USA    K2H 1C2 Canada

customerservice@veritastools.com  
[www.veritastools.com](http://www.veritastools.com)